





# HEARST PLANNING AREA OFFICIAL PLAN

## Schedule C.1: Settlement Area Plan Val Côté Township Mattice - Val Côté

### LEGEND:

-  Provincial Highway
-  Arterial Roads
-  Local Roads
-  Summer Roads
-  Settlement Area Boundary

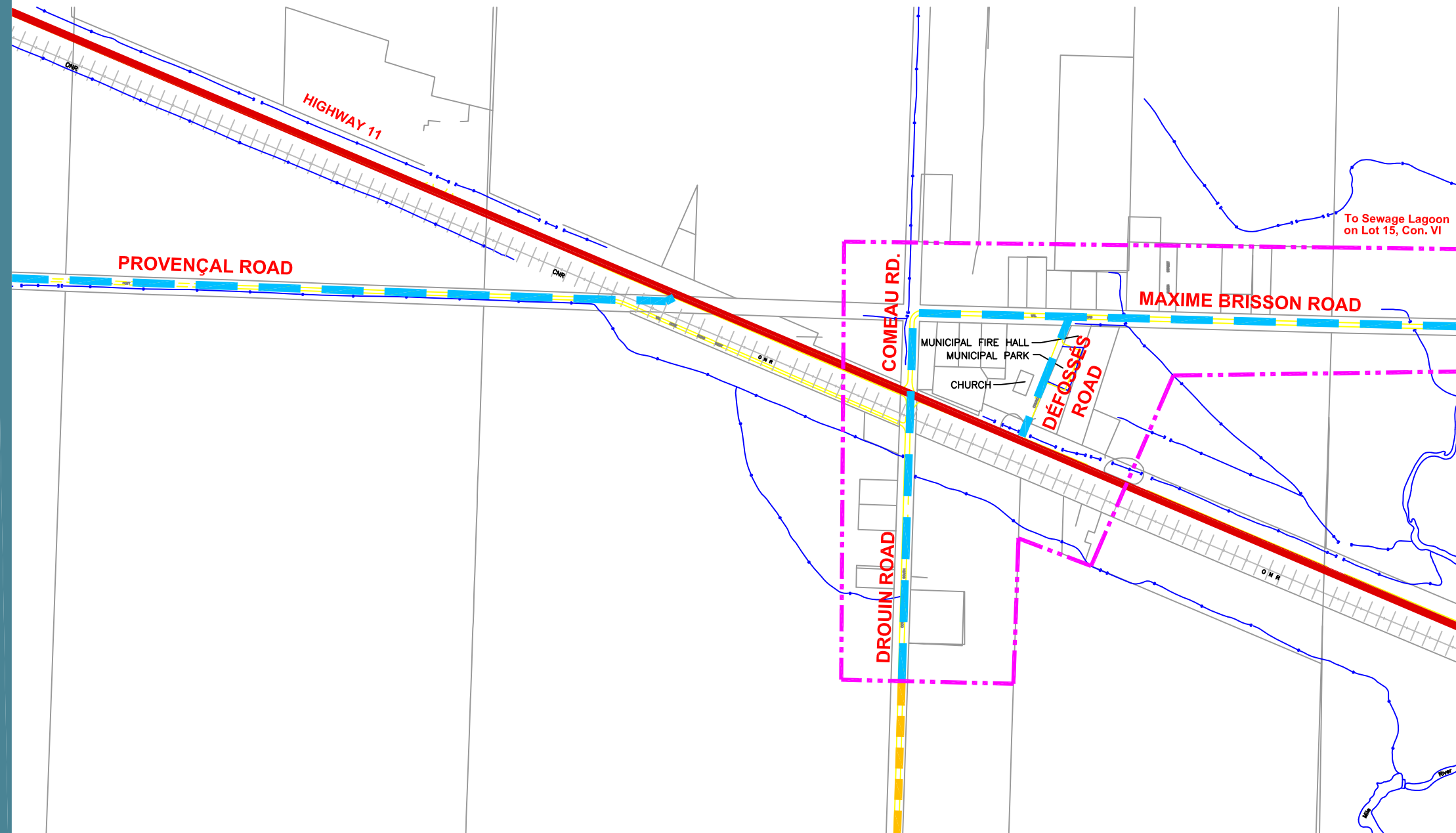

Scale: m 

Schedule Notes:  
This map is for general illustration purposes only. For boundary interpretations please contact the Township of Mattice-Val Côté.

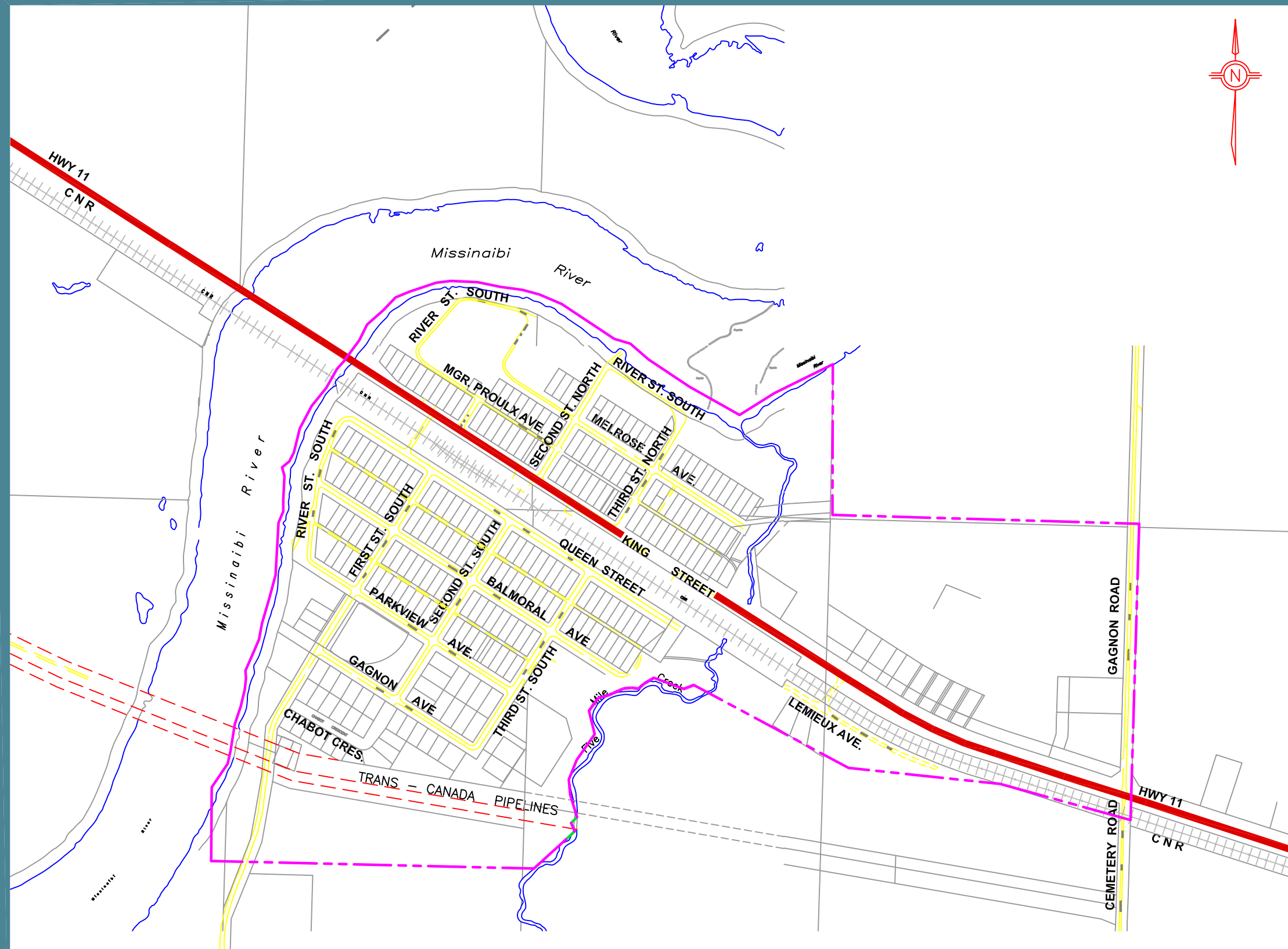

# HEARST PLANNING AREA OFFICIAL PLAN

## Schedule C.2: Settlement Area Plan Mattice Township Mattice-Val Côté

**LEGEND:**

— — — — — Settlement Area Boundary

Scale: m 0 125 250 375 500

Schedule Notes:  
This map is for general illustration purposes only. For boundary interpretations please contact the Township of Mattice-Val Côté.

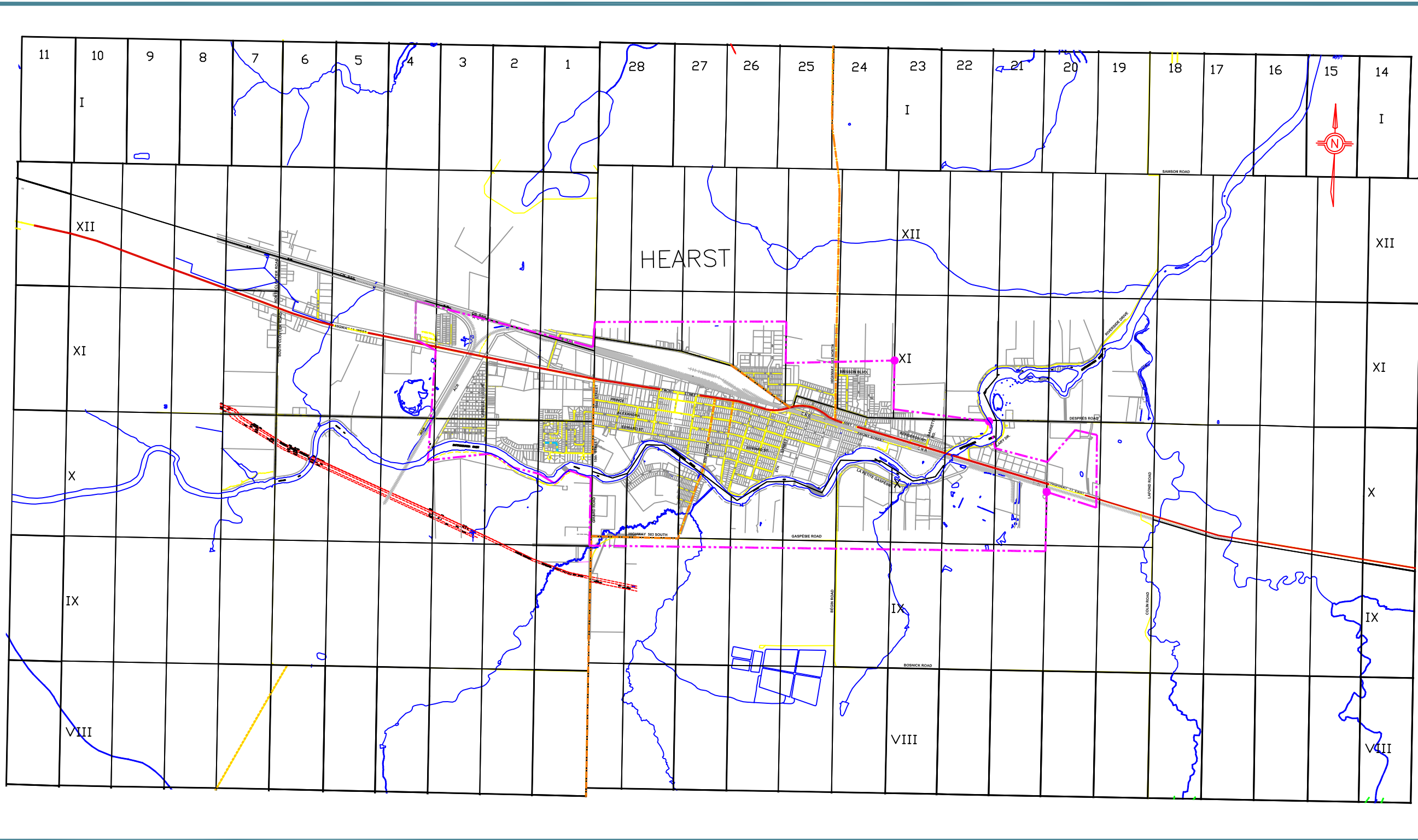

**HEARST PLANNING AREA  
OFFICIAL PLAN**

**Schedule C.3: Settlement Area Plan  
Town of Hearst**

**LEGEND:**  
 - - - - - Settlement Area Boundary





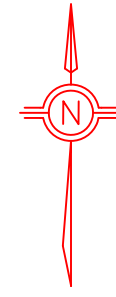

**Schedule Notes:**  
 This map is for general illustration purposes only. For boundary interpretations please contact the Town of Hearst.



# HEARST PLANNING AREA OFFICIAL PLAN

## Schedule C.4: Servicing Plan Hallébourg - Township of Kendall

- LEGEND:**
-  Provincial Highway
  -  Arterial Roads
  -  Local Roads
  -  Summer Roads
  -  Serviced Area

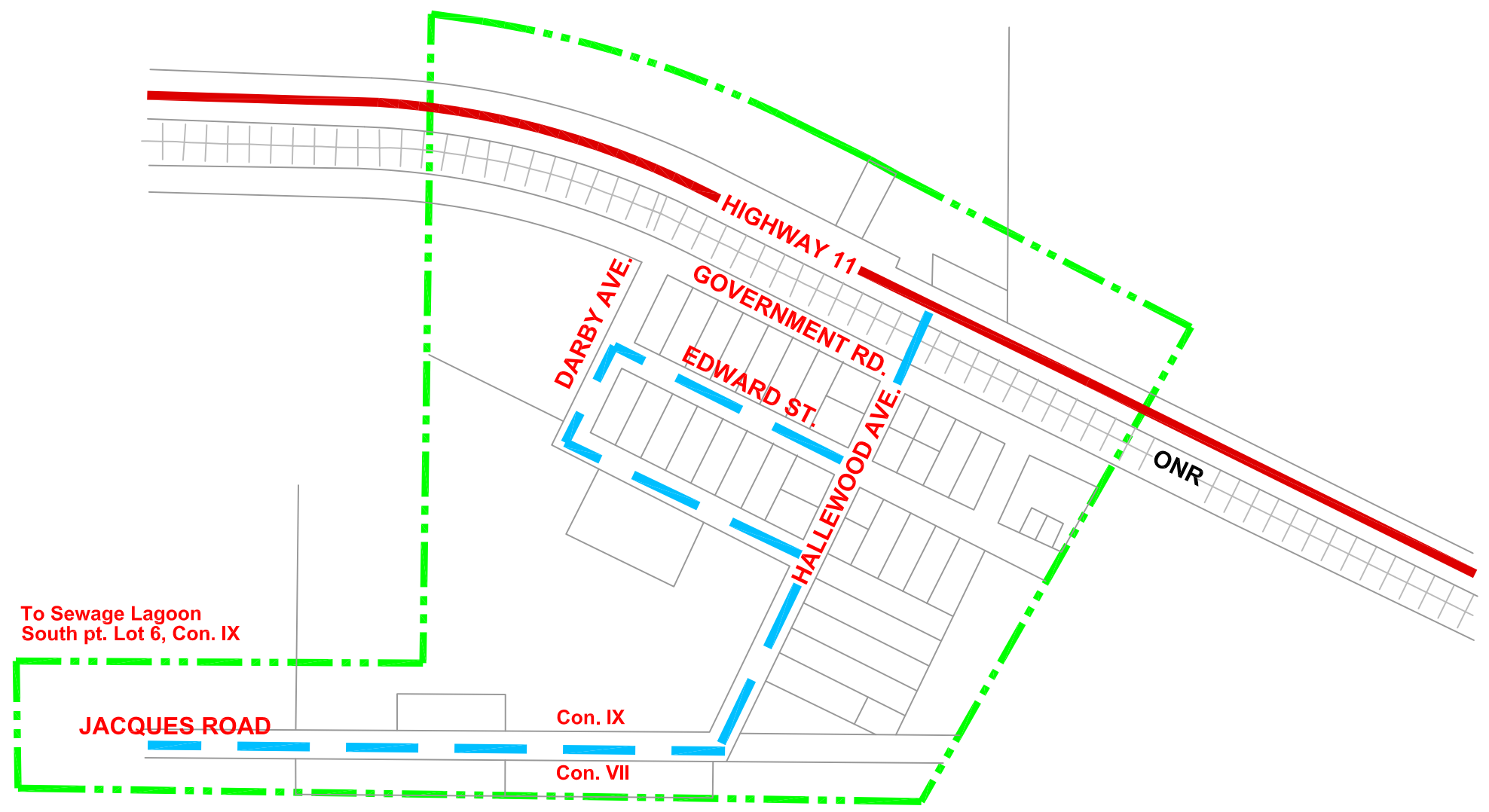



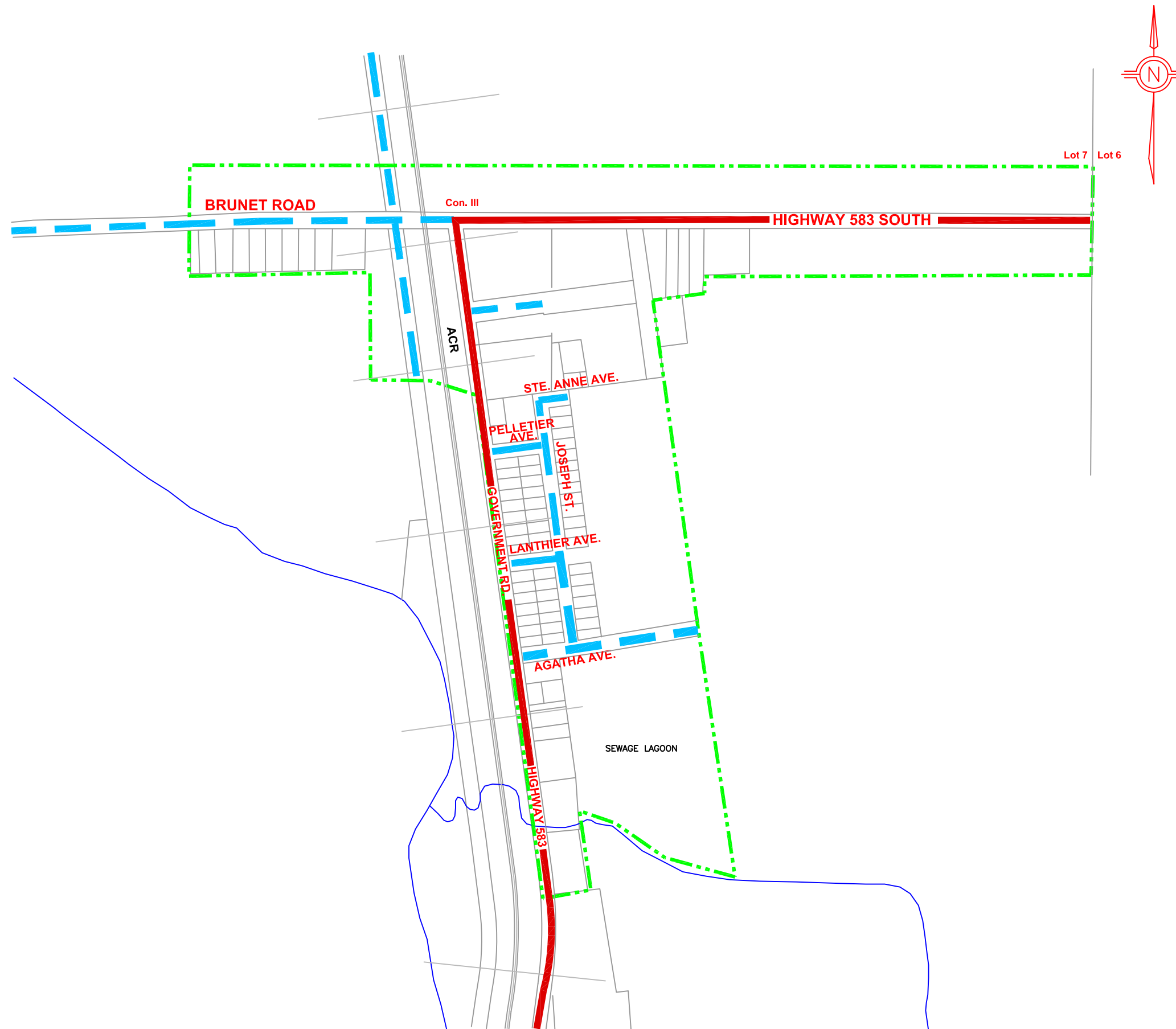

Schedule Notes:  
This map is for general illustration purposes only. For boundary interpretations please contact the Hearst Planning Board.



# HEARST PLANNING AREA OFFICIAL PLAN

## Schedule C.5: Servicing Plan Jogues - Township of Way

**LEGEND:**

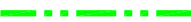
-  Provincial Highway
-  Arterial Roads
-  Local Roads
-  Summer Roads
-  Serviced Area

Scale: m 

Schedule Notes:  
This map is for general illustration purposes only. For boundary interpretations please contact the Hearst Planning Board.